



16 PHILIP SIDNEY COURT

RM16 6GX

£250,000
LEASEHOLD

CHAIN FREE!

Thomas Marsh is pleased to offer this TOP FLOOR TWO BEDROOM APARTMENT situated on the STATION SIDE of Chafford Hundred and within catchment of HARRIS ACADEMY.

This well-presented property is IDEALLY LOCATED FOR COMMUTERS and benefits from a LARGE living space, BUILT-IN WARDROBES to both bedrooms and ALLOCATED RESIDENT PARKING with SECURE GATES.

tm
thomas marsh

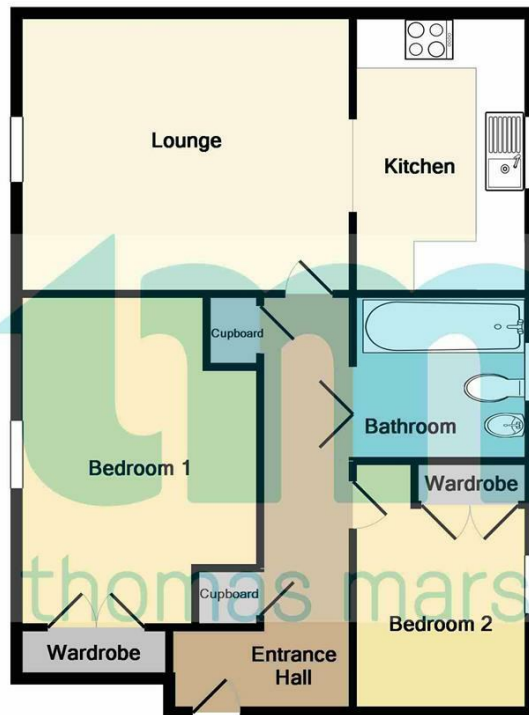

Whilst every attempt has been made to ensure the accuracy of the floor plan contained here, measurements of doors, windows, rooms and any other items are approximate and no responsibility is taken for any error, omission, or mis-statement. This plan is for illustrative purposes only and should be used as such by any prospective purchaser. The services, systems and appliances shown have not been tested and no guarantee as to their operability or efficiency can be given
Made with Metropix ©2018



| Energy Efficiency Rating | | |
|---|-------------------------|-----------|
| | Current | Potential |
| Very energy efficient - lower running costs | | |
| (92 plus) A | | |
| (81-91) B | | |
| (69-80) C | 77 | 79 |
| (55-68) D | | |
| (39-54) E | | |
| (21-38) F | | |
| (1-20) G | | |
| Not energy efficient - higher running costs | | |
| England & Wales | EU Directive 2002/91/EC | |

Agents Note: Whilst every care has been taken to prepare these particulars, they are for guidance purposes only. All measurements are approximate and are for general guidance purposes only and whilst every care has been taken to ensure their accuracy, they should not be relied upon and potential buyers/tenants are advised to recheck the measurements

Grays Lettings
47 Orsett Road
Grays
Essex
RM17 5HJ

01375 370779
lettings@thomas-marsh.com
www.thomas-marsh.com

